

# 2.54mm(.100") Wire To Wire And Wire To Board Connector

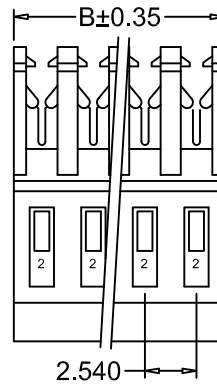

## SPECIFICATIONS:

- Current Rating:3A AC,DC
- Voltage Rating:250V AC,DC
- Operating Temperature:V2:-25°C~+85°C  
V0:-40°C~+105°C
- Contact Resistance:10mΩ max.
- Insulation Resistance:1000MΩ Min.
- Withstanding Voltage:750V AC/minute
- Material:Housing:Nylon66 UL94V-2/UL94V-0  
Terminal:Brass.Tin plated/Gold-plated
- File No:E304945

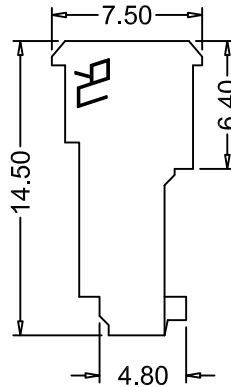
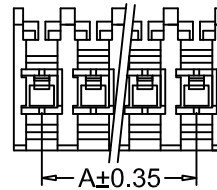
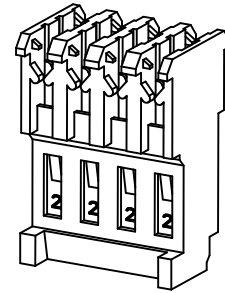

## Ordering Information And Dimensions

Part NO.	Circuits	Dimensions		Part NO.	Circuits	Dimensions		Part NO.	Circuits	Dimensions	
		Dim:A	Dim:B			Dim:A	Dim:B			Dim:A	Dim:B
M2051-2-R	2	2.54	5.08	M2051-10-R	10	22.86	25.40	M2051-18-R	18	43.18	45.72
M2051-3-R	3	5.08	7.62	M2051-11-R	11	25.40	27.94	M2051-19-R	19	45.72	48.26
M2051-4-R	4	7.62	10.16	M2051-12-R	12	27.94	30.48	M2051-20-R	20	48.26	50.80
M2051-5-R	5	10.16	12.70	M2051-13-R	13	30.48	33.02	M2051-21-R	21	50.80	53.34
M2051-6-R	6	12.70	15.24	M2051-14-R	14	33.02	35.56	M2051-22-R	22	53.34	55.88
M2051-7-R	7	15.24	17.78	M2051-15-R	15	35.56	38.10	M2051-23-R	23	55.88	58.42
M2051-8-R	8	17.78	20.32	M2051-16-R	16	38.10	40.64	M2051-24-R	24	58.42	60.96
M2051-9-R	9	20.32	22.86	M2051-17-R	17	40.64	43.18				

